

Cell Lifter (#90040)

1. Description

Cell Lifters are specially designed for easy scraping of attached cells on culture dish and well plate surfaces. Individual packing eliminates possible changes of contamination during cell culture.

2. Features

- ❖ Ideal for the manual harvesting of cells
- ❖ Two blade types on a single handle
- ❖ Wide blade types are ideal for dish and 6 well plates

3. Functional Test

Sterilized	:	Passed
Cytotoxicity	:	Passed
Non-Pyrogenic	:	Passed
RNase/DNase free	:	Passed
DNA free	:	Passed

4. Product Range

Cat. No.	Material	Length (mm)	Blade Width (mm)	Sterile	Packaging
90040	PP	218	23.00 / 12.00	+	1 / 100

5. Certification

SPL Life Sciences hereby certifies that the product identified above, inspected to be in compliance with product quality specification and requirements as documented in our ISO 9001:2008 Quality Management System (K-QA-Q031478) in Korea.

6. Product Photographs

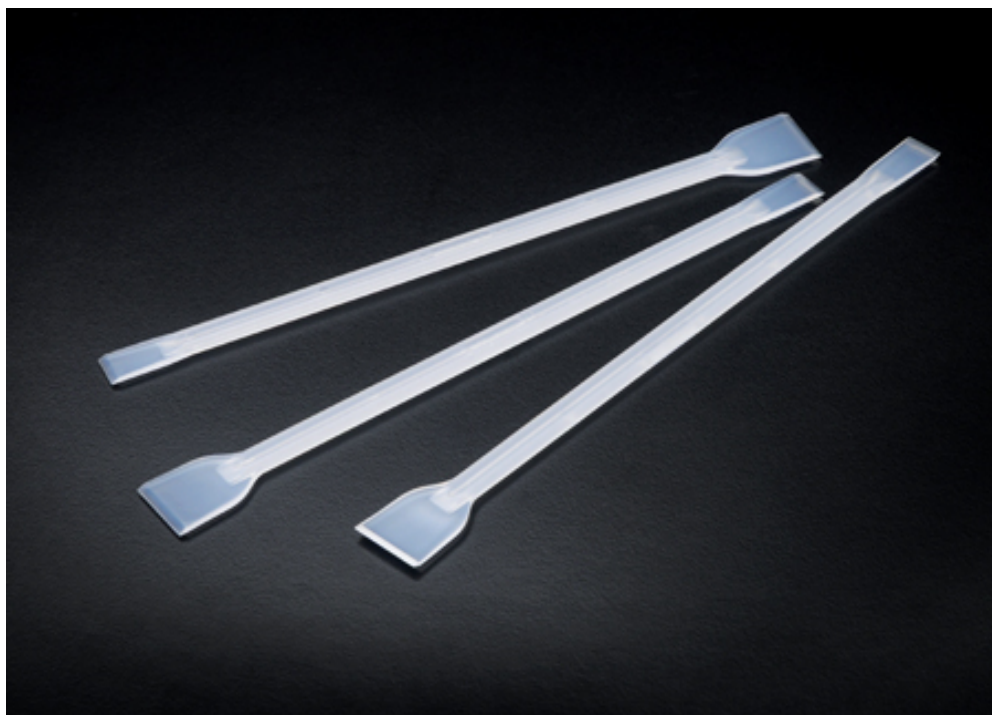

7. Specifications & Technical Drawing

- Specifications

Dimensions		Material (Resin)	Packaging
Blade Width	23.00 / 12.00 mm	Polypropylene (PP)	<ul style="list-style-type: none"> ▪ Pieces/Sleeve: 1 ▪ Pieces/Case: 100
Length:	218.00 mm		

- Technical Drawing

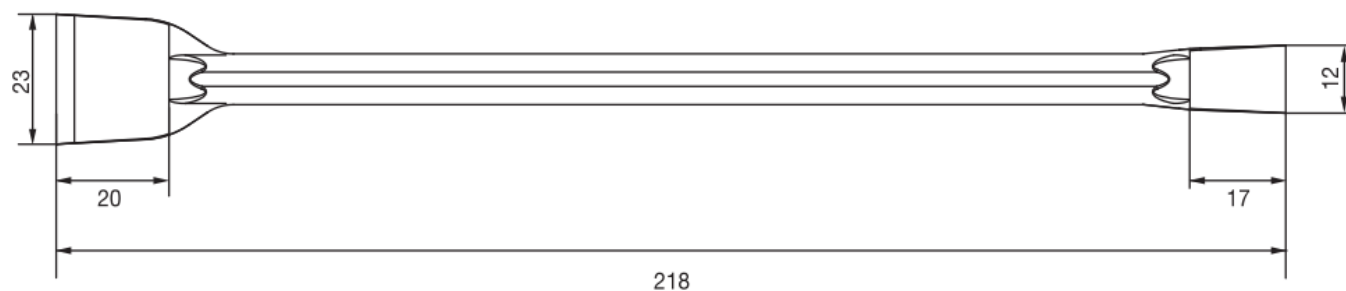

www.spllifesciences.com

For technical assistance, contact SPL R&D Center at:

Tel: +82-31-533-4800; Fax: +82-31-533-1430; e-mail: spl@ispl.co.kr

To place an order, contact your local distributor or

Tel: +82-31-533-4800; Fax: +82-31-533-1430; e-mail: business@ispl.co.kr

SPL-TDS-CLI

For Research Use Only. Not intended for use in diagnostic or therapeutic procedures.
© SPL Life Sciences Co., Ltd., Version 2, July 1st, 2016